

CWC 3-11-22



# TRAFFIC CRASH REPORT

\*DENOTES MANDATORY FIELD FOR SUPPLEMENT REPORT

LOCAL REPORT NUMBER \*

<input checked="" type="checkbox"/> PHOTOS TAKEN <input checked="" type="checkbox"/> OH-2 <input type="checkbox"/> OH-3 <input type="checkbox"/> SECONDARY CRASH <input type="checkbox"/> OH-1P <input type="checkbox"/> OTHER <input type="checkbox"/> PRIVATE PROPERTY		LOCAL INFORMATION <b>22MPD0382</b>		<b>22MPD0382</b>				
REPORTING AGENCY NAME * Millersburg		NCIC * 03801		HIT/SKIP 1 - SOLVED 2 - UNSOLVED	NUMBER OF UNITS 1	UNIT IN ERROR 98 - ANIMAL 99 - UNKNOWN		
COUNTY* 38	LOCALITY* 2	LOCATION: CITY, VILLAGE, TOWNSHIP* Millersburg			CRASH DATE / TIME* 03/05/2022 07:37	CRASH SEVERITY 1 - FATAL 5 2 - SERIOUS INJURY SUSPECTED 3 - MINOR INJURY SUSPECTED 4 - INJURY POSSIBLE 5 - PROPERTY DAMAGE ONLY		
LOCATION ROUTE TYPE ROUTE NUMBER PREFIX 1 - NORTH 2 - SOUTH 3 - EAST 4 - WEST 2	LOCATION ROAD NAME Monroe	ROAD TYPE ST	LATITUDE DECIMAL DEGREES 40.546608	LONGITUDE DECIMAL DEGREES -81.916120				
REFERENCE ROUTE TYPE ROUTE NUMBER PREFIX 1 - NORTH 2 - SOUTH 3 - EAST 4 - WEST 2	REFERENCE ROAD NAME (ROAD, MILEPOST, HOUSE #) 696	ROAD TYPE	LONGITUDE DECIMAL DEGREES	ROADWAY DIVIDED				
REFERENCE POINT 1 - INTERSECTION 3	DIRECTION FROM REFERENCE 1 - NORTH 2 - SOUTH 3 - EAST 4 - WEST 2	ROUTE TYPE IR - INTERSTATE ROUTE (TP) US - FEDERAL US ROUTE SR - STATE ROUTE CR - NUMBERED COUNTY ROUTE TR - NUMBERED TOWNSHIP ROUTE	ROAD TYPE AL - ALLEY AV - AVENUE BL - BOULEVARD CR - CIRCLE CT - COURT DR - DRIVE HE - HEIGHTS	ROAD TYPE HW - HIGHWAY LA - LANE MP - MILEPOST OV - OVAL PK - PARKWAY PI - PIKE PL - PLACE	RD - ROAD SQ - SQUARE ST - STREET TE - TERRACE TL - TRAIL WA - WAY	INTERSECTION RELATED <input type="checkbox"/> WITHIN INTERSECTION OR ON APPROACH <input type="checkbox"/> WITHIN INTERCHANGE AREA NUMBER OF APPROACHES		
DISTANCE FROM REFERENCE 94.70	DISTANCE UNIT OF MEASURE 1 - MILES 2 - FEET 3 - YARDS 2	ROUTE TYPE	ROAD TYPE	ROADWAY DIVIDED				
LOCATION OF FIRST HARMFUL EVENT 1 - ON ROADWAY 1			MANNER OF CRASH COLLISION/IMPACT 1 - NOT COLLISION 1			DIRECTION OF TRAVEL 1 - NORTH 2 - SOUTH 3 - EAST 4 - WEST	MEDIAN TYPE 1 - DIVIDED FLUSH MEDIAN (<4 FEET) 2 - DIVIDED FLUSH MEDIAN (≥4 FEET) 3 - DIVIDED, DEPRESSED MEDIAN 4 - DIVIDED, RAISED MEDIAN (ANY TYPE) 9 - OTHER / UNKNOWN	
<input type="checkbox"/> WORK ZONE RELATED <input type="checkbox"/> WORKERS PRESENT <input type="checkbox"/> LAW ENFORCEMENT PRESENT <input type="checkbox"/> ACTIVE SCHOOL ZONE	WORK ZONE TYPE 1 - LANE CLOSURE 2 - LANE SHIFT/ Crossover 3 - WORK ON SHOULDER OR MEDIAN 4 - INTERMITTENT OR MOVING WORK 5 - OTHER	LOCATION OF CRASH IN WORK ZONE 1 - BEFORE THE 1ST WORK ZONE WARNING SIGN 2 - ADVANCE WARNING AREA 3 - TRANSITION AREA 4 - ACTIVITY AREA 5 - TERMINATION AREA	CONTOUR 2	CONDITIONS 1	SURFACE 2	1 - DRY 2 - WET 3 - SNOW 4 - ICE 5 - SAND, MUD, DIRT, OIL, GRAVEL 6 - WATER (STANDING, MOVING) 7 - SLUSH 9 - OTHER / UNKNOWN	1 - CONCRETE 2 - BLACKTOP, BITUMINOUS, ASPHALT 3 - BRICK/BLOCK 4 - SLAG, GRAVEL, STONE 5 - DIRT 9 - OTHER / UNKNOWN	
LIGHT CONDITION 1 - DAYLIGHT 1	WEATHER 1 - CLEAR 1	WEATHER 6 - SNOW 7 - SEVERE CROSSWINDS 8 - BLOWING SAND, SOIL, DIRT, SNOW 9 - FREEZING RAIN OR FREEZING DRIZZLE 99 - OTHER / UNKNOWN	CONTOUR 2	CONDITIONS 1	SURFACE 2	1 - DRY 2 - WET 3 - SNOW 4 - ICE 5 - SAND, MUD, DIRT, OIL, GRAVEL 6 - WATER (STANDING, MOVING) 7 - SLUSH 9 - OTHER / UNKNOWN	1 - CONCRETE 2 - BLACKTOP, BITUMINOUS, ASPHALT 3 - BRICK/BLOCK 4 - SLAG, GRAVEL, STONE 5 - DIRT 9 - OTHER / UNKNOWN	
NARRATIVE Unit one was traveling south on South Monroe St. Unit one went straight into the woodline, failing to negotiate the curve and went straight off the roadway into the woodline, striking a tree.								
CRASH REPORTED DATE / TIME 03/05/2022 07:37		DISPATCH DATE / TIME 03/05/2022 07:38		ARRIVAL DATE / TIME 03/05/2022 07:41		SCENE CLEARED DATE / TIME 03/05/2022 08:34		REPORT TAKEN BY <input checked="" type="checkbox"/> POLICE AGENCY <input type="checkbox"/> MOTORIST
TOTAL TIME ROADWAY CLOSED	OTHER INVESTIGATION TIME	TOTAL MINUTES 56	OFFICER'S NAME* Bethel, Kaleb	CHECKED BY OFFICER'S NAME*	OFFICER'S BADGE NUMBER* 110	CHECKED BY OFFICER'S BADGE NUMBER*	<input type="checkbox"/> SUPPLEMENT (CORRECTION OR ADDITION TO AN EXISTING REPORT SENT TO ODPS)	

**UNIT #** 1 **OWNER NAME:** LAST, FIRST, MIDDLE (  SAME AS DRIVER ) **OWNER PHONE:** INCLUDE AREA CODE (  SAME AS DRIVER )  
**BROWN, BRENT, D**

**OWNER ADDRESS:** STREET, CITY, STATE, ZIP (  SAME AS DRIVER )  
**3569 N LAKESHORE DR, JAMESTOWN, OH, 45335**

**COMMERCIAL CARRIER:** NAME, ADDRESS, CITY, STATE, ZIP **COMMERCIAL CARRIER PHONE:** INCLUDE AREA CODE

**LP STATE** OH **LICENSE PLATE #** JSG8660 **VEHICLE IDENTIFICATION #** 1J4GL48K74W240033 **VEHICLE YEAR** 2004 **VEHICLE MAKE** JEEP

**INSURANCE VERIFIED** **INSURANCE COMPANY** **INSURANCE POLICY #** **COLOR** GRY **VEHICLE MODEL** LIBERTY

**COMMERCIAL**  **GOVERNMENT**  **IN EMERGENCY RESPONSE** **US DOT #** **TOWED BY:** COMPANY NAME **FINNEY'S TOWING**

**INTERLOCK DEVICE EQUIPPED**  **HIT/SKIP UNIT** **# OCCUPANTS** **VEHICLE WEIGHT GVWR/GCWR** **HAZARDOUS MATERIAL**  
 1 - ≤10K LBS. 2 - 10,001 - 26K LBS. 3 - > 26K LBS.  **MATERIAL RELEASED**  **PLACARD** **CLASS #** **PLACARD ID #**

**UNIT TYPE** **3**

1 - PASSENGER CAR	6 - VAN (9-15 SEATS)	12 - GOLF CART	18 - LIMO (LIVERY VEHICLE)	23 - PEDESTRIAN/SKATER
2 - PASSENGER VAN (MINIVAN)	7 - MOTORCYCLE 2-WHEELED	13 - SNOWMOBILE	19 - BUS (16+ PASSENGERS)	24 - WHEELCHAIR (ANY TYPE)
3 - SPORT UTILITY VEHICLE	8 - MOTORCYCLE 3-WHEELED	14 - SINGLE UNIT TRUCK	20 - OTHER VEHICLE	25 - OTHER NON-MOTORIST
4 - PICK UP	9 - AUTOCYCLE	15 - SEMI-TRACTOR	21 - HEAVY EQUIPMENT	26 - BICYCLE
5 - CARGO VAN	10 - MOPED OR MOTORIZED BICYCLE	16 - FARM EQUIPMENT	22 - ANIMAL WITH RIDER OR ANIMAL-DRAWN VEHICLE	27 - TRAIN
	11 - ALL TERRAIN VEHICLE (ATV/UTV)	17 - MOTORHOME	99 - UNKNOWN OR HIT/SKIP	

**# OF TRAILING UNITS**

**WAS VEHICLE OPERATING IN AUTONOMOUS MODE WHEN CRASH OCCURRED?** **2**

**1 - YES** **2 - NO** **9 - OTHER / UNKNOWN** **AUTONOMOUS MODE LEVEL** **0**

**0 - NO AUTOMATION** **1 - DRIVER ASSISTANCE** **3 - CONDITIONAL AUTOMATION** **4 - HIGH AUTOMATION** **9 - UNKNOWN**

**1 - PARTIAL AUTOMATION** **2 - PARTIAL AUTOMATION** **5 - FULL AUTOMATION**

**SPECIAL FUNCTION** **1**

1 - NONE	6 - BUS - CHARTER/TOUR	11 - FIRE	16 - FARM	21 - MAIL CARRIER
2 - TAXI	7 - BUS - INTERCITY	12 - MILITARY	17 - MOWING	99 - OTHER / UNKNOWN
3 - ELECTRONIC RIDE SHARING	8 - BUS - SHUTTLE	13 - POLICE	18 - SNOW REMOVAL	
4 - SCHOOL TRANSPORT	9 - BUS - OTHER	14 - PUBLIC UTILITY	19 - TOWING	
5 - BUS - TRANSIT/COMMUTER	10 - AMBULANCE	15 - CONSTRUCTION EQUIP.	20 - SAFETY SERVICE PATROL	

**CARGO BODY TYPE** **1**

1 - NO CARGO BODY TYPE / NOT APPLICABLE	4 - LOGGING	7 - GRAIN/CHIPS/GRAVEL	11 - DUMP	99 - OTHER / UNKNOWN
2 - BUS	5 - INTERMODAL CONTAINER CHASSIS	8 - POLE	12 - CONCRETE MIXER	
3 - VEHICLE TOWING ANOTHER MOTOR VEHICLE	6 - CARGOVAN / ENCLOSED BOX	9 - CARGO TANK	13 - AUTO TRANSPORTER	
		10 - FLAT BED	14 - GARBAGE/REFUSE	

**VEHICLE DEFECTS** **1**

1 - TURN SIGNALS	4 - BRAKES	7 - WORN OR SLICK TIRES	9 - MOTOR TROUBLE	99 - OTHER / UNKNOWN
2 - HEAD LAMPS	5 - STEERING	8 - TRAILER EQUIPMENT DEFECTIVE	10 - DISABLED FROM PRIOR ACCIDENT	
3 - TAIL LAMPS	6 - TIRE BLOWOUT			

**NON-MOTORIST LOCATION AT IMPACT** **1**

1 - INTERSECTION - MARKED CROSSWALK	4 - MIDBLOCK - MARKED CROSSWALK	7 - SHOULDER/ROADSIDE	10 - DRIVEWAY ACCESS	99 - OTHER / UNKNOWN
2 - INTERSECTION - UNMARKED CROSSWALK	5 - TRAVEL LANE - OTHER LOCATION	8 - SIDEWALK	11 - SHARED USE PATHS OR TRAILS	
3 - INTERSECTION - OTHER	6 - BICYCLE LANE	9 - MEDIAN/CROSSING ISLAND	12 - FIRST RESPONDER AT INCIDENT SCENE	

**ACTION** **3** **PRE-CRASH ACTIONS** **1**

1 - NON-CONTACT	1 - STRAIGHT AHEAD	9 - LEAVING TRAFFIC LANE	15 - WALKING, RUNNING, JOGGING, PLAYING	21 - STANDING OUTSIDE DISABLED VEHICLE
2 - NON-COLLISION	2 - BACKING	10 - PARKED	16 - WORKING	99 - OTHER / UNKNOWN
3 - STRIKING	3 - CHANGING LANES	11 - SLOWING OR STOPPED IN TRAFFIC	17 - PUSHING VEHICLE	
4 - STRUCK	4 - OVERTAKING/PASSING	12 - DRIVERLESS	18 - APPROACHING OR LEAVING VEHICLE	
5 - BOTH STRIKING & STRUCK	5 - MAKING RIGHT TURN	13 - NEGOTIATING A CURVE	19 - STANDING	
9 - OTHER / UNKNOWN	6 - MAKING LEFT TURN	14 - ENTERING OR CROSSING - SPECIFIED LOCATION	20 - OTHER NON-MOTORIST	
	7 - MAKING U-TURN			
	8 - ENTERING TRAFFIC LANE			

**CONTRIBUTING CIRCUMSTANCES** **11**

1 - NONE	8 - FOLLOWING TOO CLOSE /ACDA	13 - IMPROPER START FROM A PARKED POSITION	18 - OPERATING DEFECTIVE EQUIPMENT	23 - OPENING DOOR INTO ROADWAY
2 - FAILURE TO YIELD	9 - IMPROPER LANE CHANGE	14 - STOPPED OR PARKED ILLEGALLY	19 - LOAD SHIFTING /FALLING/SPILLING	99 - OTHER IMPROPER ACTION
3 - RAN RED LIGHT	10 - IMPROPER PASSING	15 - SWERVING TO AVOID	20 - IMPROPER CROSSING	
4 - RAN STOP SIGN	11 - DROVE OFF ROAD	16 - WRONG WAY	21 - LYING IN ROADWAY	
5 - UNSAFE SPEED	12 - IMPROPER BACKING	17 - VISION OBSTRUCTION	22 - NOT DISCERNIBLE	
6 - IMPROPER TURN				
7 - LEFT OF CENTER				

**SEQUENCE OF EVENTS**

**1** **9** **1** **37** **2** **48** **3** **4** **5** **6** **1**

**EVENTS**

1 - OVERTURN/ROLLOVER	7 - SEPARATION OF UNITS	12 - DOWNHILL RUNAWAY	19 - ANIMAL - OTHER	23 - STRUCK BY FALLING, SHIFTING CARGO OR ANYTHING SET IN MOTION BY A MOTOR VEHICLE
2 - FIRE/EXPLOSION	8 - RAN OFF ROAD RIGHT	13 - OTHER NON-COLLISION	20 - MOTOR VEHICLE IN TRANSPORT	24 - OTHER MOVABLE OBJECT
3 - IMMERSION	9 - RAN OFF ROAD LEFT	14 - PEDESTRIAN	21 - PARKED MOTOR VEHICLE	
4 - JACKKNIFE	10 - CROSS MEDIAN	15 - PEDALCYCLE	22 - WORK ZONE MAINTENANCE EQUIPMENT	
5 - CARGO / EQUIPMENT LOSS OR SHIFT	11 - CROSS CENTERLINE - OPPOSITE DIRECTION OF TRAVEL	16 - RAILWAY VEHICLE		
6 - EQUIPMENT FAILURE		17 - ANIMAL - FARM		
		18 - ANIMAL - DEER		

**COLLISION WITH FIXED OBJECT - STRUCK:**

25 - IMPACT ATTENUATOR / CRASH CUSHION	31 - GUARDRAIL END	38 - OVERHEAD SIGN POST	45 - EMBANKMENT
26 - BRIDGE OVERHEAD STRUCTURE	32 - PORTABLE BARRIER	39 - LIGHT / LUMINARIES SUPPORT	46 - FENCE
27 - BRIDGE PIER OR ABUTMENT	33 - MEDIUM CABLE BARRIER	40 - UTILITY POLE	47 - MAILBOX
28 - BRIDGE PARAPET	34 - MEDIUM GUARDRAIL BARRIER	41 - OTHER POST, POLE OR SUPPORT	48 - TREE
29 - BRIDGE RAIL	35 - MEDIUM CONCRETE BARRIER	42 - CULVERT	49 - FIRE HYDRANT
30 - GUARDRAIL FACE	36 - MEDIUM OTHER BARRIER	43 - CURB	50 - WORK ZONE MAINTENANCE EQUIPMENT
	37 - TRAFFIC SIGN POST	44 - DITCH	51 - WALL
			52 - BUILDING
			53 - TUNNEL
			54 - OTHER FIXED OBJECT
			99 - OTHER / UNKNOWN

**FIRST HARMFUL EVENT** **1** **MOST HARMFUL EVENT** **3**

**LOCAL REPORT NUMBER**  
**22MPD0382**

**DAMAGE**

**DAMAGE SCALE**

**4** 1 - NONE 3 - FUNCTIONAL DAMAGE  
 2 - MINOR DAMAGE 4 - DISABLING DAMAGE  
 9 - UNKNOWN

**DAMAGED AREA(S)**  
 INDICATE ALL THAT APPLY

**NO DAMAGE [ 0 ]**  **UNDERCARRIAGE [ 14 ]**  
 **TOP [ 13 ]**  **ALL AREAS [ 15 ]**  
 **UNIT NOT AT SCENE [ 16 ]**

**INITIAL POINT OF CONTACT**

**12** 0 - NO DAMAGE 14 - UNDERCARRIAGE  
 1-12 - REFER TO UNIT DIAGRAM 15 - VEHICLE NOT AT SCENE  
 13 - TOP 99 - UNKNOWN

**TRAFFIC**

**TRAFFICWAY FLOW** **2**  
 1 - ONE-WAY  
 2 - TWO-WAY

**TRAFFIC CONTROL** **6**  
 1 - ROUNDABOUT 4 - STOP SIGN  
 2 - SIGNAL 5 - YIELD SIGN  
 3 - FLASHER 6 - NO CONTROL

**# OF THROUGH LANES ON ROAD** **2**

**RAIL GRADE CROSSING**  
 1 - NOT INVOLVED  
 2 - INVOLVED-ACTIVE CROSSING  
 3 - INVOLVED-PASSIVE CROSSING

**UNIT / NON-MOTORIST DIRECTION**

FROM **1** TO **2**

**UNIT SPEED** **35**

**DETECTED SPEED** **1**  
 1 - STATED / ESTIMATED SPEED  
 2 - CALCULATED / EDR  
 3 - UNDETERMINED

**POSTED SPEED** **25**



# MOTORIST / Non-MOTORIST

LOCAL REPORT NUMBER

22MPD0382

<b>UNIT #</b> 1	<b>NAME: LAST, FIRST, MIDDLE</b>				<b>DATE OF BIRTH</b>		<b>AGE</b>	<b>GENDER</b>					
<b>ADDRESS: STREET, CITY, STATE, ZIP</b> , OH					<b>CONTACT PHONE - INCLUDE AREA CODE</b>								
<b>INJURIES</b> 5	<b>INJURED TAKEN BY</b> 1	<b>EMS AGENCY (NAME)</b>		<b>INJURED TAKEN TO: MEDICAL FACILITY (NAME, CITY)</b>		<b>SAFETY EQUIPMENT USED</b> 99	<input type="checkbox"/> DOT-COMPLIANT <input type="checkbox"/> MC HELMET	<b>SEATING POSITION</b>	<b>AIR BAG USAGE</b>	<b>EJECTION</b>	<b>TRAPPED</b>		
<b>OL STATE</b>	<b>OPERATOR LICENSE NUMBER</b>		<b>OFFENSE CHARGED</b>		<b>LOCAL CODE</b> <input type="checkbox"/>	<b>OFFENSE DESCRIPTION</b>			<b>CITATION NUMBER</b>				
<b>OL CLASS</b>	<b>ENDORSEMENT</b>	<b>RESTRICTION SELECT UP TO 3</b>		<b>DRIVER DISTRACTED BY</b>	<b>ALCOHOL / DRUG SUSPECTED</b> <input type="checkbox"/> ALCOHOL <input type="checkbox"/> MARIJUANA <input type="checkbox"/> OTHER DRUG		<b>CONDITION</b>	<b>ALCOHOL TEST</b>		<b>DRUG TEST(S)</b>			
								<b>STATUS</b>	<b>TYPE</b>	<b>VALUE</b>	<b>STATUS</b>	<b>TYPE</b>	<b>RESULTS SELECT UP TO 4</b>

<b>UNIT #</b>	<b>NAME: LAST, FIRST, MIDDLE</b>				<b>DATE OF BIRTH</b>		<b>AGE</b>	<b>GENDER</b>					
<b>ADDRESS: STREET, CITY, STATE, ZIP</b>					<b>CONTACT PHONE - INCLUDE AREA CODE</b>								
<b>INJURIES</b>	<b>INJURED TAKEN BY</b>	<b>EMS AGENCY (NAME)</b>		<b>INJURED TAKEN TO: MEDICAL FACILITY (NAME, CITY)</b>		<b>SAFETY EQUIPMENT USED</b>	<input type="checkbox"/> DOT-COMPLIANT <input type="checkbox"/> MC HELMET	<b>SEATING POSITION</b>	<b>AIR BAG USAGE</b>	<b>EJECTION</b>	<b>TRAPPED</b>		
<b>OL STATE</b>	<b>OPERATOR LICENSE NUMBER</b>		<b>OFFENSE CHARGED</b>		<b>LOCAL CODE</b> <input type="checkbox"/>	<b>OFFENSE DESCRIPTION</b>			<b>CITATION NUMBER</b>				
<b>OL CLASS</b>	<b>ENDORSEMENT</b>	<b>RESTRICTION SELECT UP TO 3</b>		<b>DRIVER DISTRACTED BY</b>	<b>ALCOHOL / DRUG SUSPECTED</b> <input type="checkbox"/> ALCOHOL <input type="checkbox"/> MARIJUANA <input type="checkbox"/> OTHER DRUG		<b>CONDITION</b>	<b>ALCOHOL TEST</b>		<b>DRUG TEST(S)</b>			
								<b>STATUS</b>	<b>TYPE</b>	<b>VALUE</b>	<b>STATUS</b>	<b>TYPE</b>	<b>RESULTS SELECT UP TO 4</b>

<b>UNIT #</b>	<b>NAME: LAST, FIRST, MIDDLE</b>				<b>DATE OF BIRTH</b>		<b>AGE</b>	<b>GENDER</b>					
<b>ADDRESS: STREET, CITY, STATE, ZIP</b>					<b>CONTACT PHONE - INCLUDE AREA CODE</b>								
<b>INJURIES</b>	<b>INJURED TAKEN BY</b>	<b>EMS AGENCY (NAME)</b>		<b>INJURED TAKEN TO: MEDICAL FACILITY (NAME, CITY)</b>		<b>SAFETY EQUIPMENT USED</b>	<input type="checkbox"/> DOT-COMPLIANT <input type="checkbox"/> MC HELMET	<b>SEATING POSITION</b>	<b>AIR BAG USAGE</b>	<b>EJECTION</b>	<b>TRAPPED</b>		
<b>OL STATE</b>	<b>OPERATOR LICENSE NUMBER</b>		<b>OFFENSE CHARGED</b>		<b>LOCAL CODE</b> <input type="checkbox"/>	<b>OFFENSE DESCRIPTION</b>			<b>CITATION NUMBER</b>				
<b>OL CLASS</b>	<b>ENDORSEMENT</b>	<b>RESTRICTION SELECT UP TO 3</b>		<b>DRIVER DISTRACTED BY</b>	<b>ALCOHOL / DRUG SUSPECTED</b> <input type="checkbox"/> ALCOHOL <input type="checkbox"/> MARIJUANA <input type="checkbox"/> OTHER DRUG		<b>CONDITION</b>	<b>ALCOHOL TEST</b>		<b>DRUG TEST(S)</b>			
								<b>STATUS</b>	<b>TYPE</b>	<b>VALUE</b>	<b>STATUS</b>	<b>TYPE</b>	<b>RESULTS SELECT UP TO 4</b>

INJURIES	SEATING POSITION	AIR BAG	OL CLASS	OL RESTRICTION(S)	DRIVER DISTRACTION	TEST STATUS
1 - FATAL 2 - SUSPECTED SERIOUS INJURY 3 - SUSPECTED MINOR INJURY 4 - POSSIBLE INJURY 5 - NO APPARENT INJURY	1 - FRONT - LEFT SIDE (MOTORCYCLE DRIVER) 2 - FRONT - MIDDLE 3 - FRONT - RIGHT SIDE 4 - SECOND - LEFT SIDE (MOTORCYCLE PASSENGER) 5 - SECOND - MIDDLE 6 - SECOND - RIGHT SIDE 7 - THIRD - LEFT SIDE (MOTORCYCLE SIDE CAR) 8 - THIRD - MIDDLE 9 - THIRD - RIGHT SIDE 10 - SLEEPER SECTION OF TRUCK CAB 11 - PASSENGER IN OTHER ENCLOSED CARGO AREA (NON-TRAILING UNIT, BUS, PICK-UP WITH CAP) 12 - PASSENGER IN UNENCLOSED CARGO AREA 13 - TRAILING UNIT 14 - RIDING ON VEHICLE EXTERIOR (NON-TRAILING UNIT) 15 - NON-MOTORIST 99 - OTHER / UNKNOWN	1 - NOT DEPLOYED 2 - DEPLOYED FRONT 3 - DEPLOYED SIDE 4 - DEPLOYED BOTH FRONT/SIDE 5 - NOT APPLICABLE 9 - DEPLOYMENT UNKNOWN	1 - CLASS A 2 - CLASS B 3 - CLASS C 4 - REGULAR CLASS (OHIO = D) 5 - M/C MOPED ONLY 6 - NO VALID OL	1 - ALCOHOL INTERLOCK DEVICE 2 - CDL INTRASTATE ONLY 3 - CORRECTIVE LENSES 4 - FARM WAIVER 5 - EXCEPT CLASS A BUS & CLASS B BUS 6 - EXCEPT CLASS A 7 - EXCEPT TRACTOR-TRAILER 8 - INTERMEDIATE LICENSE RESTRICTIONS 9 - LEARNER'S PERMIT RESTRICTIONS 10 - LIMITED TO DAYLIGHT ONLY 11 - LIMITED TO EMPLOYMENT 12 - LIMITED - OTHER 13 - MECHANICAL DEVICES (SPECIAL BRAKES, HAND CONTROLS, OR OTHER ADAPTIVE DEVICES) 14 - MILITARY VEHICLES ONLY 15 - MOTOR VEHICLES WITHOUT AIR BRAKES 16 - OUTSIDE MIRROR 17 - PROSTHETIC AID 18 - OTHER	1 - NOT DISTRACTED 2 - MANUALLY OPERATING AN ELECTRONIC COMMUNICATION DEVICE (TEXTING, TYPING, DIALING) 3 - TALKING ON HANDS-FREE COMMUNICATION DEVICE 4 - TALKING ON HAND-HELD COMMUNICATION DEVICE 5 - OTHER ACTIVITY WITH AN ELECTRONIC DEVICE 6 - PASSENGER 7 - OTHER DISTRACTION INSIDE THE VEHICLE 8 - OTHER DISTRACTION OUTSIDE THE VEHICLE 9 - OTHER / UNKNOWN	1 - NONE GIVEN 2 - TEST REFUSED 3 - TEST GIVEN, CONTAMINATED SAMPLE / UNUSABLE 4 - TEST GIVEN, RESULTS KNOWN 5 - TEST GIVEN, RESULTS UNKNOWN
INJURIES TAKEN BY	EJECTION		OL ENDORSEMENT	CONDITION		ALCOHOL TEST TYPE
1 - NOT TRANSPORTED / TREATED AT SCENE 2 - EMS 3 - POLICE 9 - OTHER / UNKNOWN	1 - NOT EJECTED 2 - PARTIALLY EJECTED 3 - TOTALLY EJECTED 4 - NOT APPLICABLE		H - HAZMAT M - MOTORCYCLE P - PASSENGER N - TANKER Q - MOTOR SCOOTER R - THREE-WHEEL MOTORCYCLE S - SCHOOL BUS T - DOUBLE & TRIPLE TRAILERS X - TANKER / HAZMAT	1 - APPARENTLY NORMAL 2 - PHYSICAL IMPAIRMENT 3 - EMOTIONAL (E.G. DEPRESSED, ANGRY, DISTURBED) 4 - ILLNESS 5 - FELL ASLEEP, FAINTED, FATIGUED, ETC. 6 - UNDER THE INFLUENCE OF MEDICATIONS / DRUGS / ALCOHOL 9 - OTHER / UNKNOWN		1 - NONE 2 - BLOOD 3 - URINE 4 - BREATH 5 - OTHER
SAFETY EQUIPMENT	TRAPPED		GENDER		DRUG TEST TYPE	
1 - NONE USED 2 - SHOULDER BELT ONLY USED 3 - LAP BELT ONLY USED 4 - SHOULDER & LAP BELT USED 5 - CHILD RESTRAINT SYSTEM - FORWARD FACING 6 - CHILD RESTRAINT SYSTEM - REAR FACING 7 - BOOSTER SEAT 8 - HELMET USED 9 - PROTECTIVE PADS USED (ELBOWS, KNEES, ETC) 10 - REFLECTIVE CLOTHING 11 - LIGHTING - PEDESTRIAN / BICYCLE ONLY 99 - OTHER / UNKNOWN	1 - NOT TRAPPED 2 - EXTRICATED BY MECHANICAL MEANS 3 - FREED BY NON-MECHANICAL MEANS		F - FEMALE M - MALE U - OTHER / UNKNOWN		1 - NONE 2 - BLOOD 3 - URINE 4 - OTHER	
<b>DRUG TEST RESULT(S)</b>						
1 - AMPHETAMINES 2 - BARBITURATES 3 - BENZODIAZEPINES 4 - CANNABINOIDS 5 - COCAINE 6 - OPIATES / OPIOIDS 7 - OTHER 8 - NEGATIVE RESULTS						



# OCCUPANT / WITNESS ADDENDUM

LOCAL REPORT NUMBER

22MPD0382

UNIT #	NAME: LAST, FIRST, MIDDLE	DATE OF BIRTH	AGE	GENDER
--------	---------------------------	---------------	-----	--------

ADDRESS: STREET, CITY, STATE, ZIP	CONTACT PHONE - INCLUDE AREA CODE
-----------------------------------	-----------------------------------

INJURIES	INJURED TAKEN BY	EMS AGENCY (NAME)	INJURED TAKEN TO: MEDICAL FACILITY (NAME, CITY)	SAFETY EQUIPMENT	<input type="checkbox"/> DOT-COMPLIANT MC HELMET	SEATING POSITION	AIR BAG USAGE	EJECTION	TRAPPED
----------	------------------	-------------------	---	------------------	--	------------------	---------------	----------	---------

UNIT #	NAME: LAST, FIRST, MIDDLE	DATE OF BIRTH	AGE	GENDER
--------	---------------------------	---------------	-----	--------

ADDRESS: STREET, CITY, STATE, ZIP	CONTACT PHONE - INCLUDE AREA CODE
-----------------------------------	-----------------------------------

INJURIES	INJURED TAKEN BY	EMS AGENCY (NAME)	INJURED TAKEN TO: MEDICAL FACILITY (NAME, CITY)	SAFETY EQUIPMENT	<input type="checkbox"/> DOT-COMPLIANT MC HELMET	SEATING POSITION	AIR BAG USAGE	EJECTION	TRAPPED
----------	------------------	-------------------	---	------------------	--	------------------	---------------	----------	---------

UNIT #	NAME: LAST, FIRST, MIDDLE	DATE OF BIRTH	AGE	GENDER
--------	---------------------------	---------------	-----	--------

ADDRESS: STREET, CITY, STATE, ZIP	CONTACT PHONE - INCLUDE AREA CODE
-----------------------------------	-----------------------------------

INJURIES	INJURED TAKEN BY	EMS AGENCY (NAME)	INJURED TAKEN TO: MEDICAL FACILITY (NAME, CITY)	SAFETY EQUIPMENT	<input type="checkbox"/> DOT-COMPLIANT MC HELMET	SEATING POSITION	AIR BAG USAGE	EJECTION	TRAPPED
----------	------------------	-------------------	---	------------------	--	------------------	---------------	----------	---------

UNIT #	NAME: LAST, FIRST, MIDDLE	DATE OF BIRTH	AGE	GENDER
--------	---------------------------	---------------	-----	--------

ADDRESS: STREET, CITY, STATE, ZIP	CONTACT PHONE - INCLUDE AREA CODE
-----------------------------------	-----------------------------------

INJURIES	INJURED TAKEN BY	EMS AGENCY (NAME)	INJURED TAKEN TO: MEDICAL FACILITY (NAME, CITY)	SAFETY EQUIPMENT	<input type="checkbox"/> DOT-COMPLIANT MC HELMET	SEATING POSITION	AIR BAG USAGE	EJECTION	TRAPPED
----------	------------------	-------------------	---	------------------	--	------------------	---------------	----------	---------

INJURIES	SAFETY EQUIPMENT USED	SEATING POSITION	AIR BAG USAGE
1 - FATAL	1 - NONE USED - VEHICLE OCCUPANT	1 - FRONT - LEFT SIDE (MOTORCYCLE DRIVER)	1 - NOT DEPLOYED
2 - SUSPECTED SERIOUS INJURY	2 - SHOULDER BELT ONLY USED	2 - FRONT - MIDDLE	2 - DEPLOYED FRONT
3 - SUSPECTED MINOR INJURY	3 - LAP BELT ONLY USED	3 - FRONT - RIGHT SIDE	3 - DEPLOYED SIDE
4 - POSSIBLE INJURY	4 - SHOULDER & LAP BELT USED	4 - SECOND - LEFT SIDE (MOTORCYCLE PASSENGER)	4 - DEPLOYED BOTH FRONT/SIDE
5 - NO APPARENT INJURY	5 - CHILD RESTRAINT SYSTEM - FORWARD FACING	5 - SECOND - MIDDLE	5 - NOT APPLICABLE
	6 - CHILD RESTRAINT SYSTEM - REAR FACING	6 - SECOND - RIGHT SIDE	9 - DEPLOYMENT UNKNOWN
	7 - BOOSTER SEAT	7 - THIRD - LEFT SIDE (MOTORCYCLE SIDE CAR)	
	8 - HELMET USED	8 - THIRD - MIDDLE	<b>EJECTION</b>
	9 - PROTECTIVE PADS USED (ELBOWS, KNEES, ETC)	9 - THIRD - RIGHT SIDE	1 - NOT EJECTED
	10 - REFLECTIVE CLOTHING	10 - SLEEPER SECTION OF TRUCK CAB	2 - PARTIALLY EJECTED
	11 - LIGHTING - PEDESTRIAN / BICYCLE ONLY	11 - PASSENGER IN OTHER ENCLOSED CARGO AREA (NON-TRAILING UNIT SUCH AS A BUS, PICK-UP WITH CAP)	3 - TOTALLY EJECTED
	99 - OTHER / UNKNOWN	12 - PASSENGER IN UNENCLOSED CARGO AREA	4 - NOT APPLICABLE
		13 - TRAILING UNIT	<b>TRAPPED</b>
		14 - RIDING ON VEHICLE EXTERIOR (NON-TRAILING UNIT)	1 - NOT TRAPPED
		15 - NON-MOTORIST	2 - EXTRICATED BY MECHANICAL MEANS
		99 - OTHER / UNKNOWN	3 - FREED BY NON-MECHANICAL MEANS

NAME: LAST, FIRST, MIDDLE	DATE OF BIRTH	AGE	GENDER
---------------------------	---------------	-----	--------

ADDRESS: STREET, CITY, STATE, ZIP	CONTACT PHONE - INCLUDE AREA CODE
-----------------------------------	-----------------------------------

NAME: LAST, FIRST, MIDDLE	DATE OF BIRTH	AGE	GENDER
---------------------------	---------------	-----	--------

ADDRESS: STREET, CITY, STATE, ZIP	CONTACT PHONE - INCLUDE AREA CODE
-----------------------------------	-----------------------------------

NAME: LAST, FIRST, MIDDLE	DATE OF BIRTH	AGE	GENDER
---------------------------	---------------	-----	--------

ADDRESS: STREET, CITY, STATE, ZIP	CONTACT PHONE - INCLUDE AREA CODE
-----------------------------------	-----------------------------------

OHIO TRAFFIC ACCIDENT - OH2 NARRATIVE

LOCAL REPORT NUMBER <b>22MPD0382</b>	REPORTING AGENCY <b>Millersburg</b>	DATE OF CRASH <b>03/05/2022</b>
IN COUNTY OF <b>Holmes County</b>	ACCIDENT LOCATION <b>Monroe</b>	

The sign that was damaged during this incident is owned by the Village Of Millersburg. The address for the Village of Millersburg is 6 N Washington St, Millersburg, OH 44654. Phone number (330)- 674-5931

OFFICERS SIGNATURE	BADGE NO. <b>110</b>
--------------------	-------------------------

OHIO TRAFFIC ACCIDENT - DIAGRAM/NARRATIVE CONTINUATION

OH-2 (Rev. 1/82)

LOCAL REPORT NUMBER 22MPD0382	REPORTING AGENCY Millersburg Police Department	DATE OF ACCIDENT MO3 10 05 1922
IN COUNTY OF Holmes	ACCIDENT LOCATION S Monroe ST	

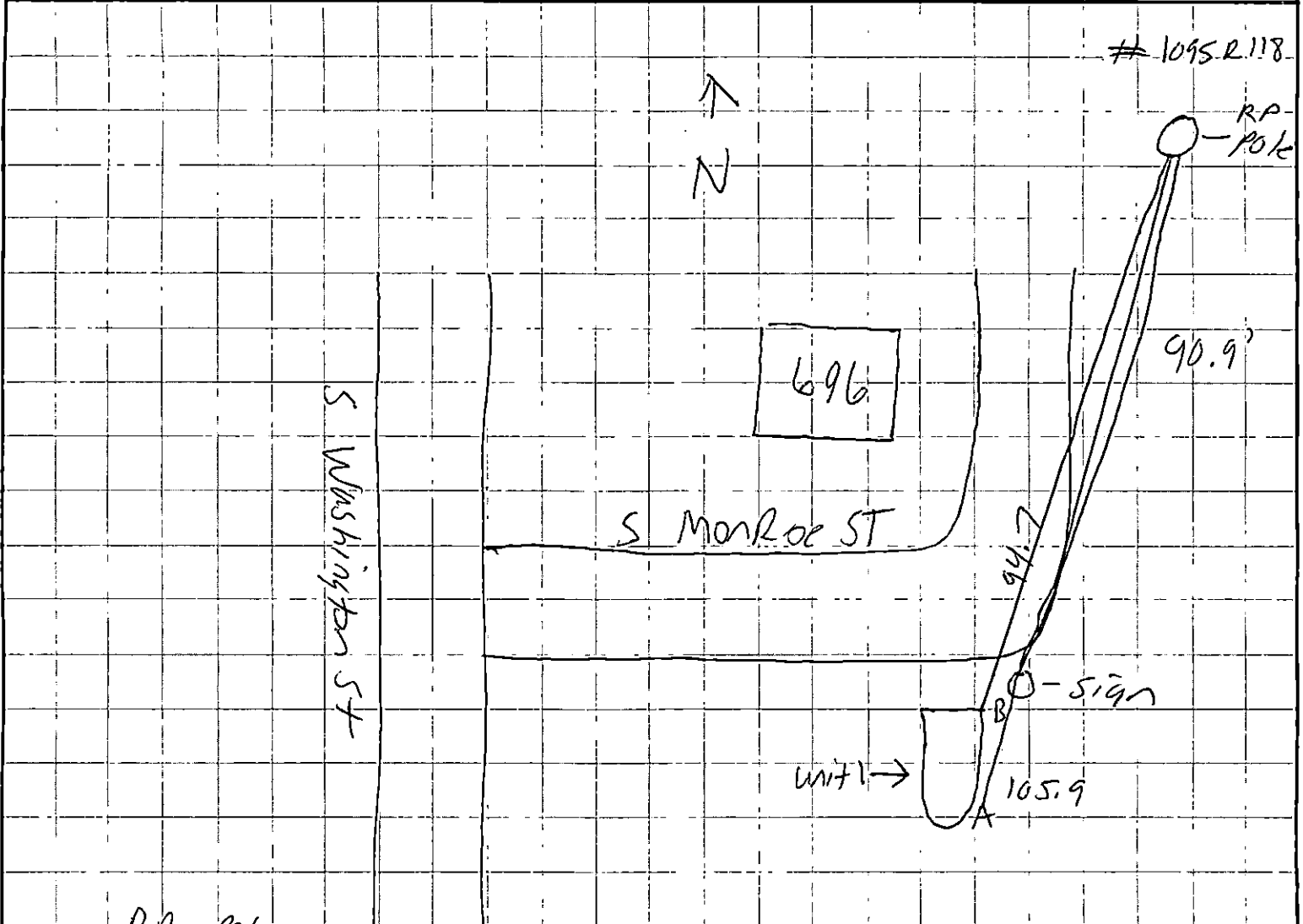

RP = pole

RP - sign = 90.9

RP - A = 105.9

RP - B = 94.7

OFFICERS SIGNATURE  
*Kurt Bittel*

BADGE NO.  
110